



Scan the code  
follow Whatsapp



Scan the code  
get the book



INTERNATIONAL HOTLINE  
**00862981506887**

**FUJISJ**

**FUJI ELEVATOR CO.,LTD**

Add: No. 287, fenghe road, lianhu district, xi'an city, Shaanxi province, China

Tel: 008602981506887    WhatsApp: +86 17392707011

Email: sales.support@elevator-fuji.com

Http: www.fujisj.com



This book is a general information publication, and we reserve the right to change the product design and description at any time.  
Any word in this book, regardless of its literal meaning or meaning, shall not be responsible for any product and the use and quality of such product, or for any expression or change of the terms of the purchase and sale contract.  
Due to the limitations of the printing process, the actual processing color may be slightly different from this volume, and the final selection can be determined according to the actual material and color swatch.

# FUJISJ CARGO ELEVATOR

**BASIC SERIES**

· CARGO ELEVATOR

· CAR ELEVATOR

· DUMBWAITER



FUJISJ

**FUJISJ**

**FUJI ELEVATOR CO.,LTD**



# FUJISJ ELEVATOR INTRODUCTION ENTERPRISE

Fuji Elevator Co., Ltd and Japan Fuji Machinery & electric Co., limited jointly created the only official Fuji brand in China-FUJISJ. The company has national standard elevator factory, covering an area of more than 400 acres, has a technical research and development team of nearly 100 people, with an annual output of 20,000 elevators and 2,000 escalators.

We provide high-speed elevators, passenger elevators, home elevators, hospital elevators, observation elevator, escalators, moving walks, freight elevators, automobile elevators etc. The company now has more than 20 series of elevator products with more than 50 specifications, and has reached the domestic and international advanced level. It is one of the largest elevator manufacturers in the elevator industry with complete product specifications, multiple categories, and maximum rated load capacity. We are committed to building the largest elevator production base in the world.

**20000+**

Annual production elevators

**2000+**

Annual production escalators

**20+**

Elevator product series

**50+**

Elevator specifications





# SCOPE & REQUIREMENTS

It has the advantages of safety and reliability, high structural strength, durability, smooth operation, and large door opening distance. It has become an ideal choice for transporting goods in factory warehouses, shopping malls, logistics centers, convention and exhibition centers, etc., and can carry out transportation work in various harsh environments.

## MR Cargo Elevator

Applicable to

- Low and medium rise buildings

Production Range of Application

- Travelling height  $\leq 30\text{m}$
- Rated capacity  $\leq 5000\text{kg}$

## MRL Cargo Elevator

Applicable to

- Low and medium rise buildings

Production Range of Application

- Travelling height  $\leq 30\text{m}$
- Rated capacity  $\leq 5000\text{kg}$

## Car Elevator

Applicable to

- Underground garage

Production Range of Application

- Travelling height  $\leq 25\text{m}$
- Rated capacity  $\leq 5000\text{kg}$

## Dumbwaiter

Applicable to

- Low and medium rise buildings

Production Range of Application

- Travelling height  $\leq 30\text{m}$
- Rated capacity  $\leq 300\text{kg}$





# CARGO ELEVATOR

## SAFETY FIRST QUALITY FIRST

### Safety first

The cargo elevator complies with global safety standards, always regards the safety as the first point of structural design.

### Solid and durable car

The car is manufactured using high-strength profiles, it has undergone multiple destructive and reliability tests to ensure that the car is strong and durable and can transport goods in various harsh environments, can work in different conditions.

### Super carrying capacity

The traction machine, safety gear, and speed limiter all adopt international standards, with a higher safety level, and the brake torque is increased, ensuring good intelligent performance and ensuring the safety of large-tonnage transportation.

### Anti-skid patterned floor--bottom of the car

The entire car bottom is specially reinforced and uses anti-skid patterned steel plates to effectively alleviate the impact of cargo on the car bottom, improve the working conditions, and ensure the dual safety of the elevator and cargo.

### The machine is powerful

Using a large-capacity host design, the inverter capacity is increased, the performance is more excellent, and the power is strong.

### The large door-opening size

The multi-fold car door is adopted to achieve the maximum door opening width, which facilitates the entry and exit of large goods.

### Excellent torque characteristics

The biggest feature of VVVF speed regulation is its constant torque characteristics, regardless of light or heavy load, its operating speed, comfort, and leveling accuracy are not affected.





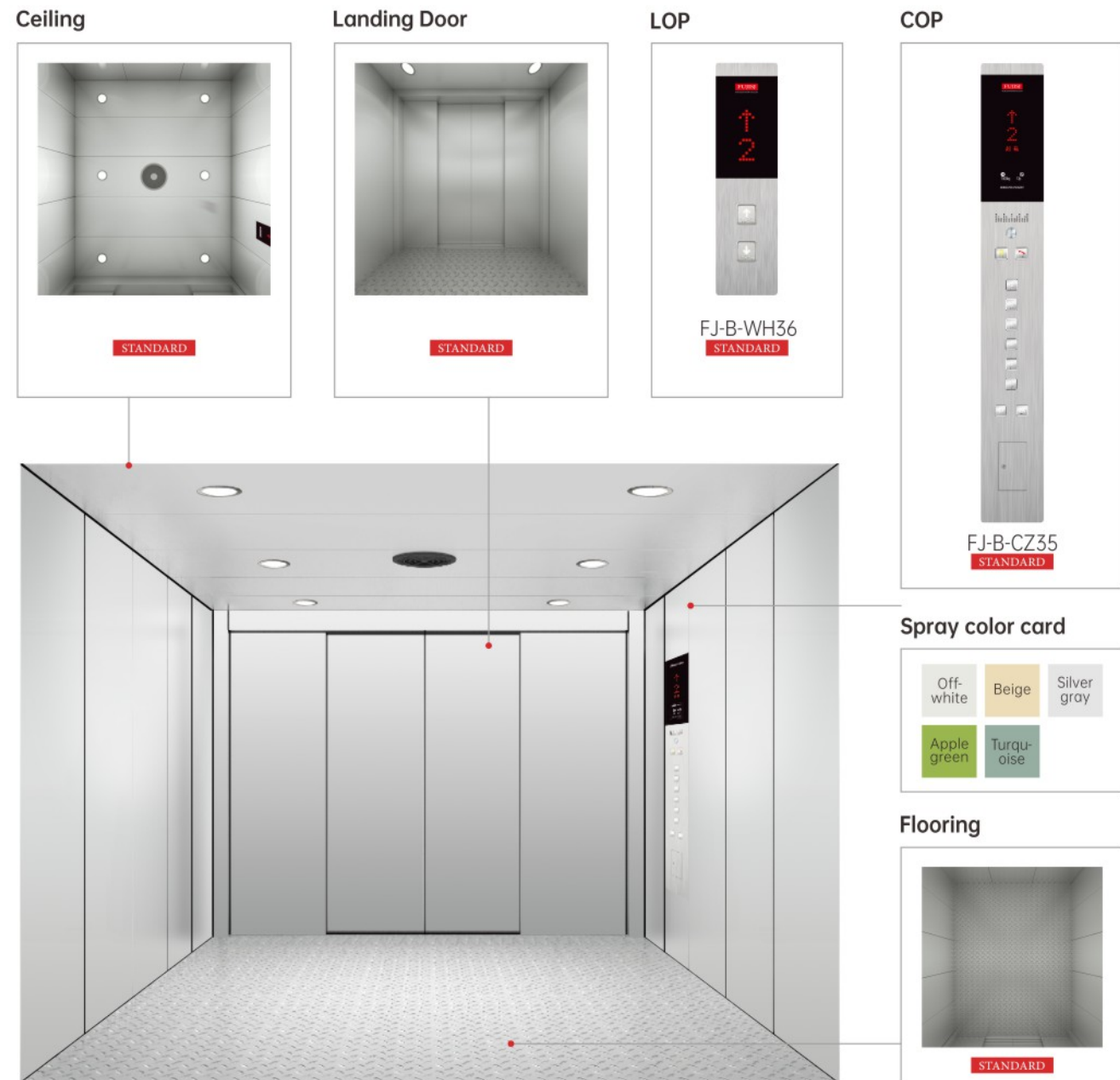

## FJ-B-HD1 STANDARD CABIN DESIGN CABIN DECORATION

<b>Ceiling</b>	Painted steel plate, downlight, fan	<b>Front wall</b>	Painted steel plate
<b>Car wall</b>	Painted steel plate	<b>Car door</b>	Painted steel plate
<b>Floor</b>	Anti-skid checkered steel plate		

CD: Customizable, CW: Customizable, HD: Customizable

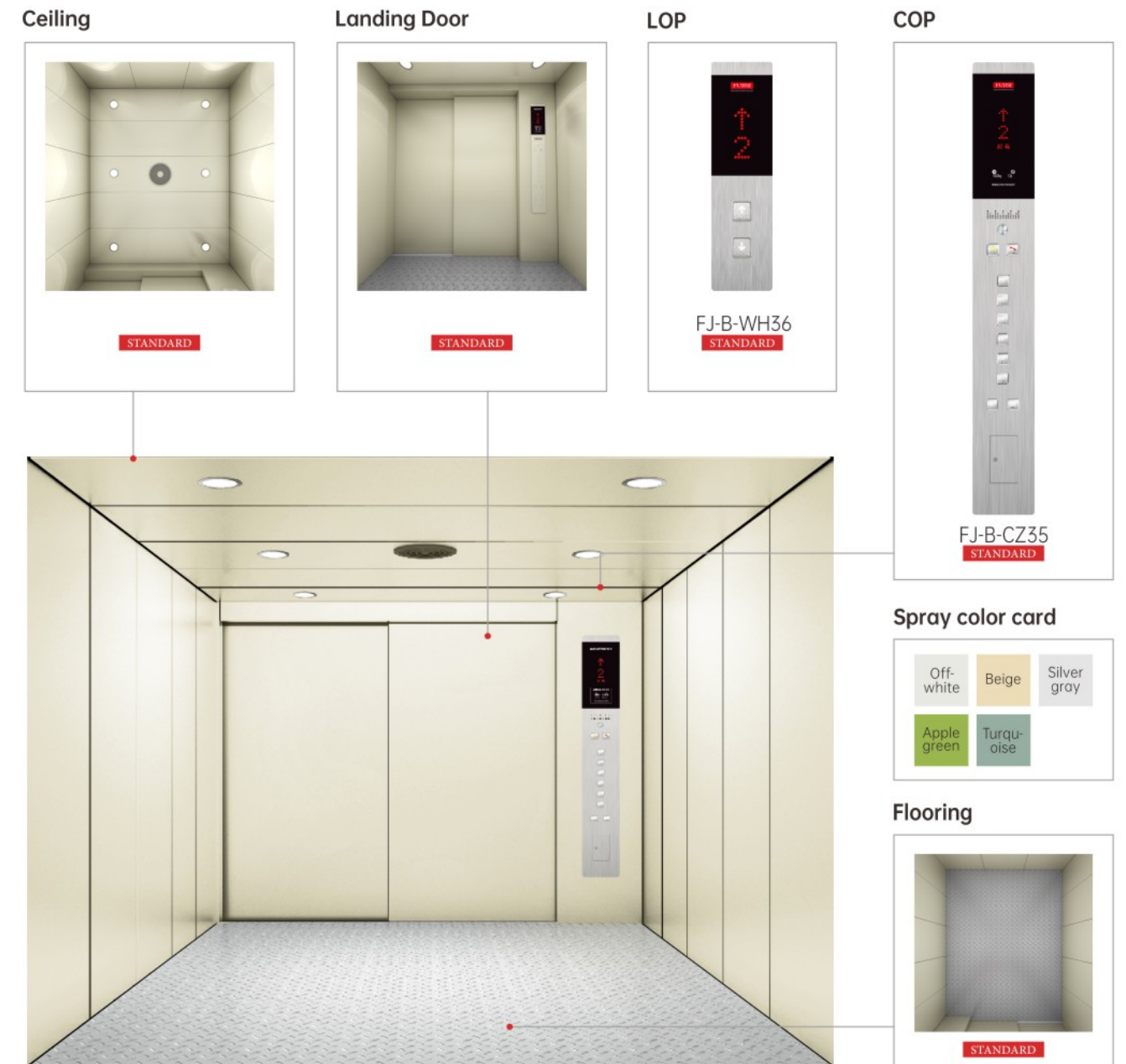

## FJ-B-HD2 STANDARD CABIN DESIGN CABIN DECORATION

<b>Ceiling</b>	Painted steel plate, downlight, fan	<b>Front wall</b>	Painted steel plate
<b>Car wall</b>	Painted steel plate	<b>Car door</b>	Painted steel plate
<b>Floor</b>	Anti-skid checkered steel plate		

CD: Customizable, CW: Customizable, HD: Customizable



# CAR ELEVATOR

**Super high and large access space**

It adopts the world's advanced technology and is specially designed according to the special needs of cars in terms of space and performance.

**4M car and 6M depth**

with higher flexibility and reliability, making it convenient for all types of cars to park with rest assured.

**Counterweight**

Realize overload protection, correctly reflect the elevator load information. when the car is overloaded, allowing passengers to adjust the load in time, and improve the elevator traction conditions.

**Dedicated circuit control and display system**

The specialized circuit control and display system is convenient for both the driver inside the cabin and the driver waiting outside the cabin.

**Safety guide device**

There is a safety guide device on the ground inside the car to ensure the safety of the elevator and the car.



Ceiling

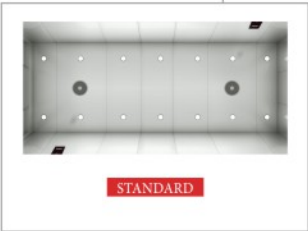

Flooring



Spray color card



COP



LOP



**FJ-B-HD3 STANDARD CABIN DESIGN**

**CABIN DECORATION**

Ceiling	Painted steel plate, downlight, fan	Front wall	Painted steel plate
Car wall	Painted steel plate	Car door	Painted steel plate
Floor	Anti-skid checkered steel plate		

CD: Customizable, CW: Customizable, HD: Customizable



CE  
certificationEAC  
certificationLight curtain  
protectionVideo  
surveillanceEmergency  
levelingEnvironmentally  
greenSmooth  
comfortable

# DUMBWAITER

It provides fast, convenient and economical vertical transportation for small freight elevators in various buildings, greatly saving time and human resources. It can be widely used in hotels, restaurants, banks, hospitals and other places to transport items such as food, tableware, daily necessities and so on.

## Special designed slideway

The uniquely designed double-profile special slideway is connected and operated by a door slider in the middle, which not only enhances the smoothness of the elevator door opening, but also reduces the door panel gap and is easy to install and adjust.

## Various specifications and models

the load range is 100KG-300KG. The door style can be divided into window sill type for direct entry and exit of goods and floor-standing type for convenient entry and exit of cargo trolleys.



GROUND TYPE  
STANDARD



WINDOW TYPE  
STANDARD

FJ-B-001

STANDARD  
CABIN  
DESIGN

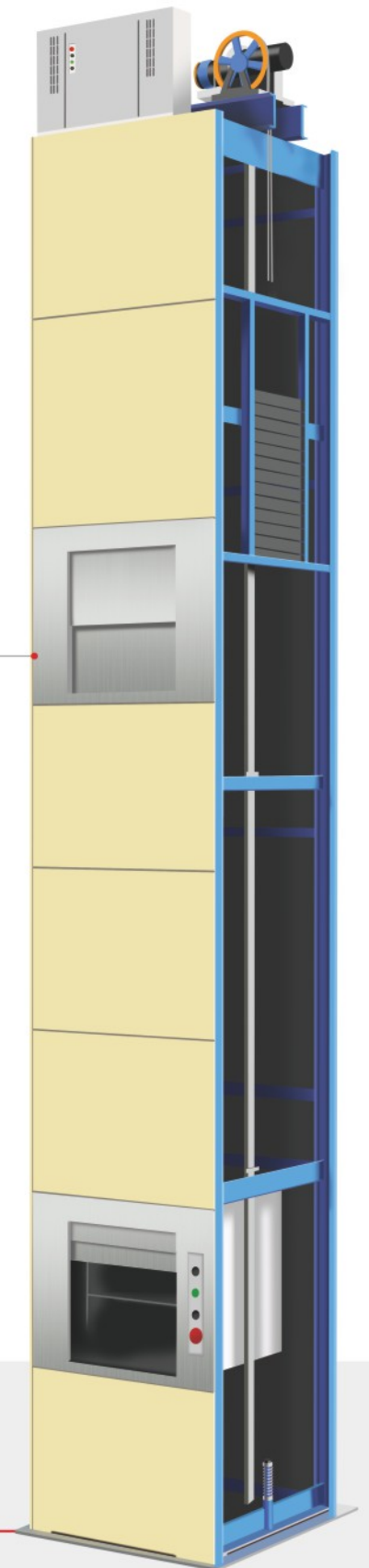



# FUNCTION TABLE OF CARGO ELEVATOR

General operating function		
Full Set Selection of Running Function	Service floor	Door open time setting function
Door open hold delay function	Service floor Settings for doors	Closing button to close the door in advance
Floor display setting	Light curtain signal self-diagnosis	Repeat closing function
Command independent function	Voice announcement function	Automatic levelling without commissioning
Acceleration section cut-off response	Lower set selection control operation function	Idle return to base station function
Changing station stop function	Forced closing function	Error command deletion function
Service layer setting function	Independent operation	Driver-operated operation
Low-speed self-rescue function	Door control selection function	Outside hall I/O expansion function
Car I/O extension function	Pushbutton sticking check	Starting torque automatic compensation
Direct stop	Optimum curve automatic generation	Suspension of service output function
Record of number of runs	Running time record	Door lock abnormality automatic door opening
VIP service function	Disabled service function	Full Load Direct Drive
Overload protection function	Fault data recording	

Inspection Related Function		
Simple maintenance keypad	Manoeuvring compartment commissioning	Shaft self-learning function
User setting check	Overhaul operation	Motor parameter tuning
Intelligent correction of floor position	Inspection two-stage speed function	Test run

Fire and safety function		
Firefighting forced landing function	Security Floor Function	Lift Lock Function
Troubleshoot faults by classification	Flying Car Prohibition Function	Automatic identification of power failure
Automatic switching of power failure operation mode	Self-recognition of power failure operation direction	Base station verification
Priority release function	Interference evaluation function	Seismic detection function
Current ramp removal	Independent working power supply function	Automatic voltage recognition

Parallel Controlling Operation and Other Functions		
Parallel control/Group control operation	Elevator spread waiting	Exit parallel control/Group control
Automatic disengagement of parallel/group control	Anti-disturbance	Parking in non-door zone indication function
Full load indication function		

Energy Saving Function Configuration		
Car energy saving function	Backup power supply energy-saving operation	Night arrival clock cancellation function

Optional function list		
Early door opening function	Micro-moving level function	Power failure rescue function
On-site commissioning assistance function	Mobile phone debugging function (English version is not supported for the time being)	Residential quarters monitoring function
IC Card Function	STO Function	No machine room monitoring function
Firefighter operation	Auxiliary control compartment function	Front and back door independent control function



CIVIL ENGINEERING PARAMETERS OF  
MR CARGO ELEVATOR

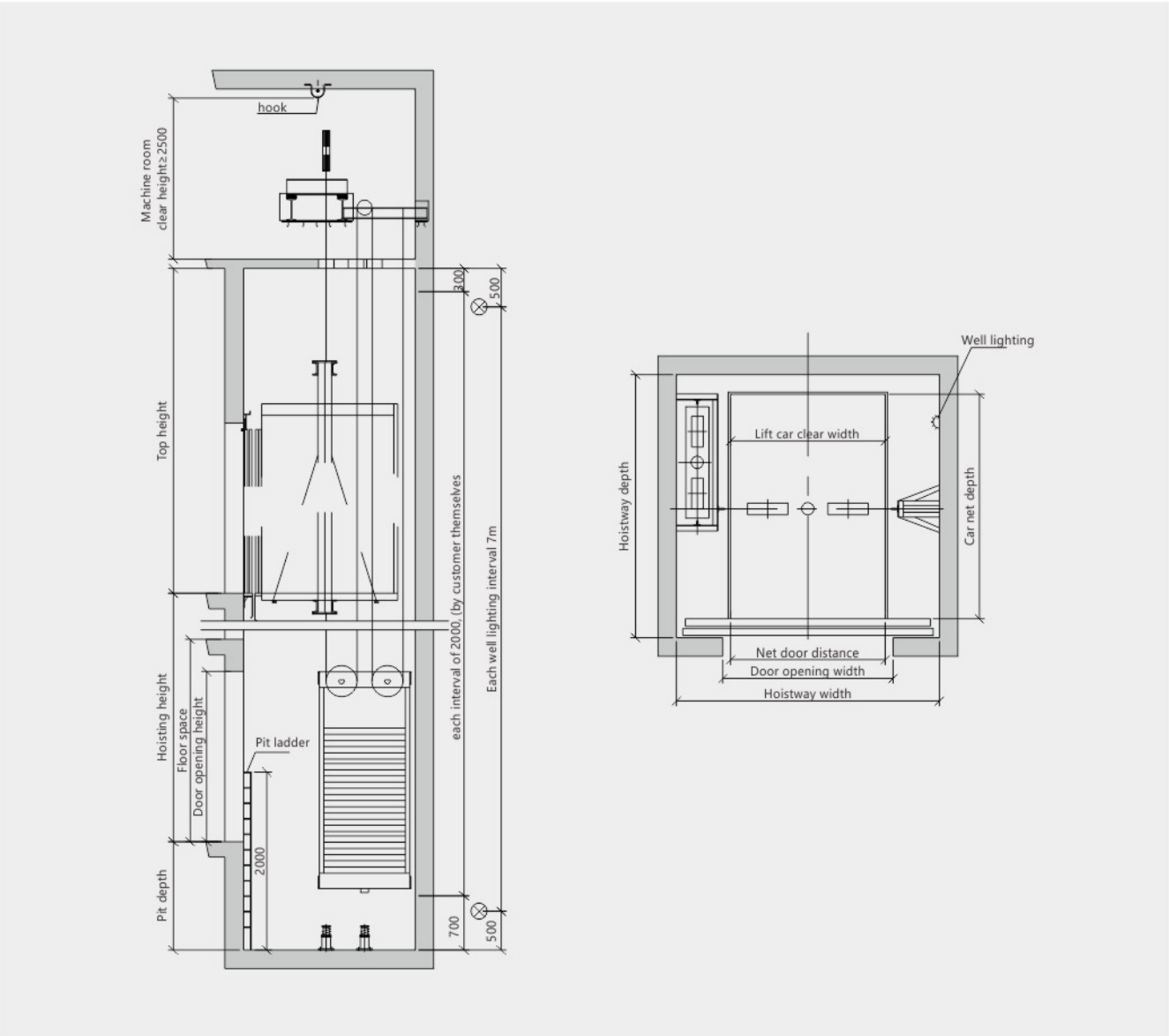

Loading capacity	Rated speed (m/s)	Door opening size (mm)	Door opening way	Car arrangement	Car size (mm)			Hoistway size (mm)		Machine room dimensions (mm)			Top height (mm)	Pit depth (mm)	Max travelling height (m)
					Width	Depth	Height	Width	Depth	Width	Depth	Height			
2000kg	0.5/1.0	1500×2100	Bifold door with centre parting	No through design	1800	2300	2200	2900	2900	3500	4000	2800	4500	1500	30
				Through design	1500	2700	2200	2900	3200		4000				
			Bi-folding door with side opening	No through design	1800	2300	2200	2800	2800		3500				
				Through design	1500	2700	2200	2800	3200		4000				
3000kg		2000×2100	Bifold door with centre parting	No through design	2000	2900	2200	3400	3400	3400	4500	5100	1700		
Through design															
4000kg		2200×2400	Bifold door with centre parting	No through design	2200	3300	2500	3750	3800	3750	4500	5100	1700		
Through design															
5000kg	2500×2400	Bifold door with centre parting	No through design	2500	3500	2500	4100	4000	4100	4000	5100	1700			
			Through design												

Note:Only for reference,final manufacture please follow contract.

CIVIL ENGINEERING PARAMETERS OF  
MRL CARGO ELEVATOR

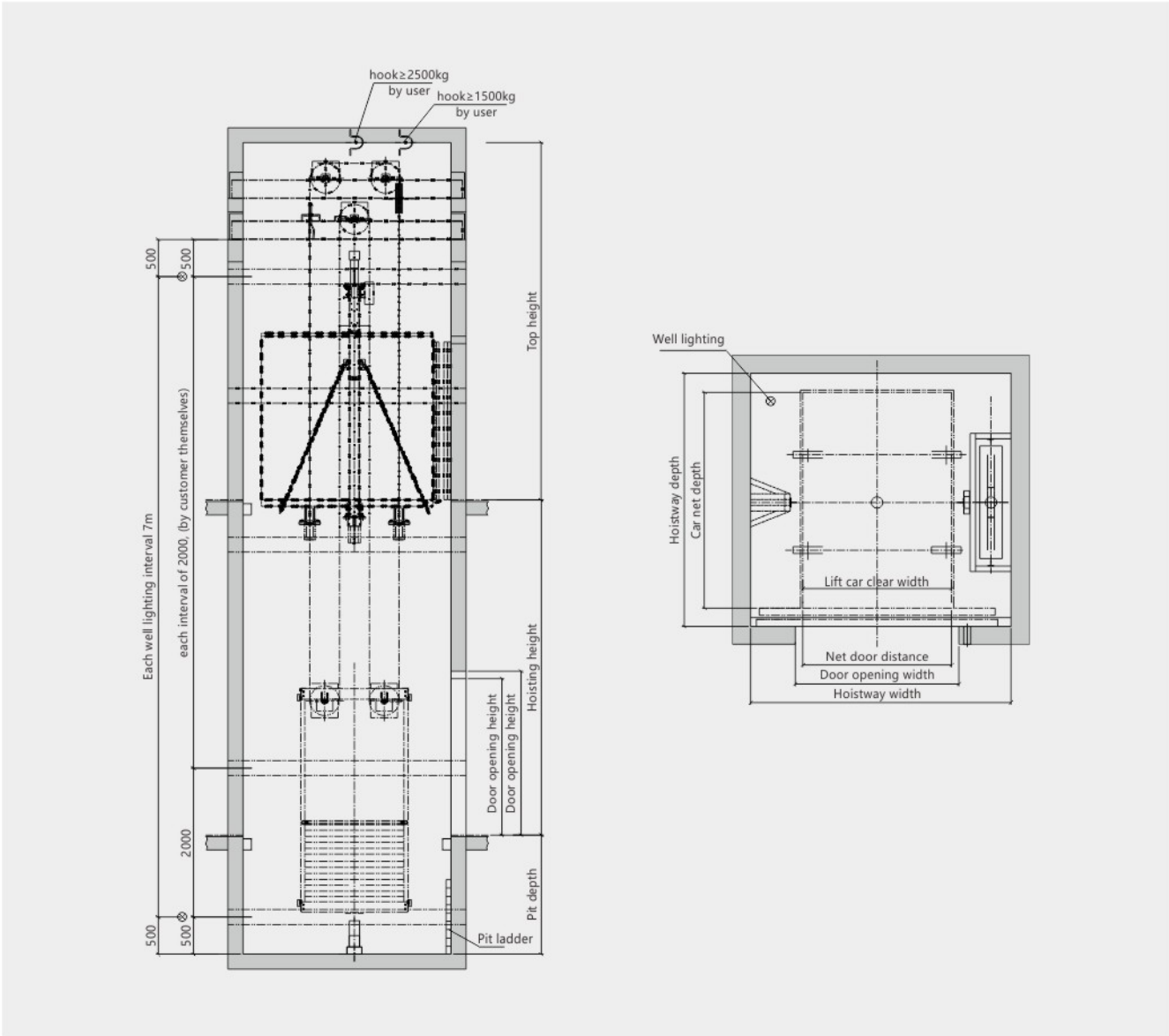

Loading capacity	Rated speed (m/s)	Door opening size (mm)	Door opening way	Car arrangement	Car size (mm)			Hoistway size (mm)		Top height (mm)	Pit depth (mm)	Max travelling height (m)
					Width	Depth	Height	Width	Depth			
1600kg	0.5/1.0	1500×2100	Bifold door with centre parting	No through design	1500	2350	2200	2900	2850	4700	1700	30
2000kg		1500×2100	Bifold door with centre parting	No through design	1700	2400		2900	2900			
				Through design	1500	2700		2900	3200			
			Bi-folding door with side opening	No through design	1700	2400		2900	2900			
				Through design	1500	2700		2900	3200			
3000kg		2000×2100	Bifold door with centre parting	No through design	2000	2900		3500	3400	5200	1700	
5000kg		2500×2400	Bifold door with centre parting	No through design				2500	3500	4200	4000	
				Through design								

Note:Only for reference,final manufacture please follow contract.



CIVIL ENGINEERING PARAMETERS OF  
CAR ELEVATOR

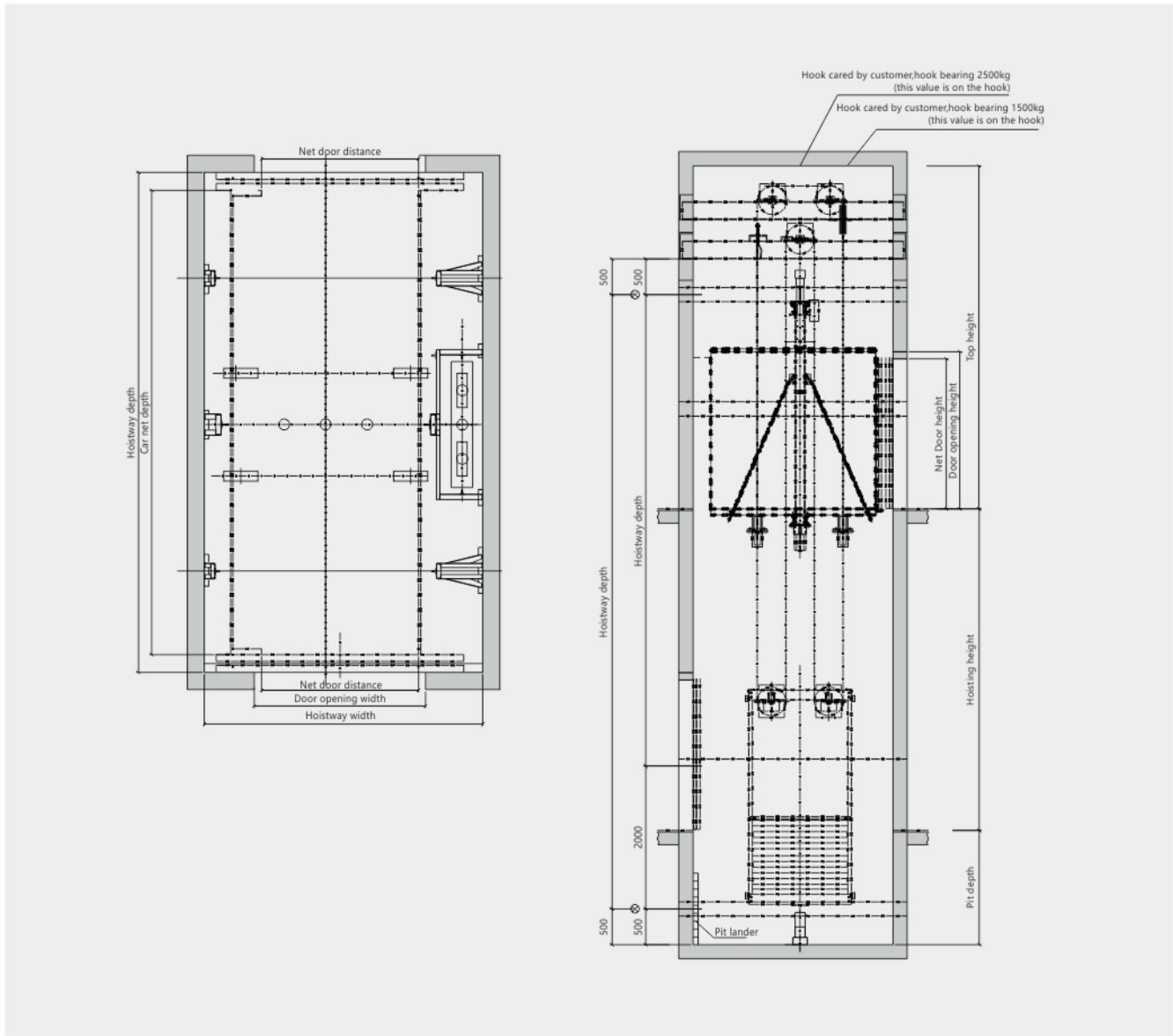

Loading capacity	Rated speed (m/s)	Door opening size (mm)	Door opening way	Car arrangement	Car size (mm)			Hoistway size (mm)		Top height (mm)	Pit depth (mm)
					Width	Depth	Height	Width	Depth		
3000kg	0.5/1.0	2400×2200	Bifold door with centre parting	No through design	2700	5500	2500	4000	6200	5500	1800
				Through design	2700	5500	2500	4000	6200		
5000kg	0.5/1.0	2500×2200	Bifold door with centre parting	No through design	2900	6000	2500	4200	6700	5500	1800
				Through design	2900	6000	2500	4200	6600		

Note:Only for reference,final manufacture please follow contract.

CIVIL ENGINEERING PARAMETERS OF  
DUMBWAITER

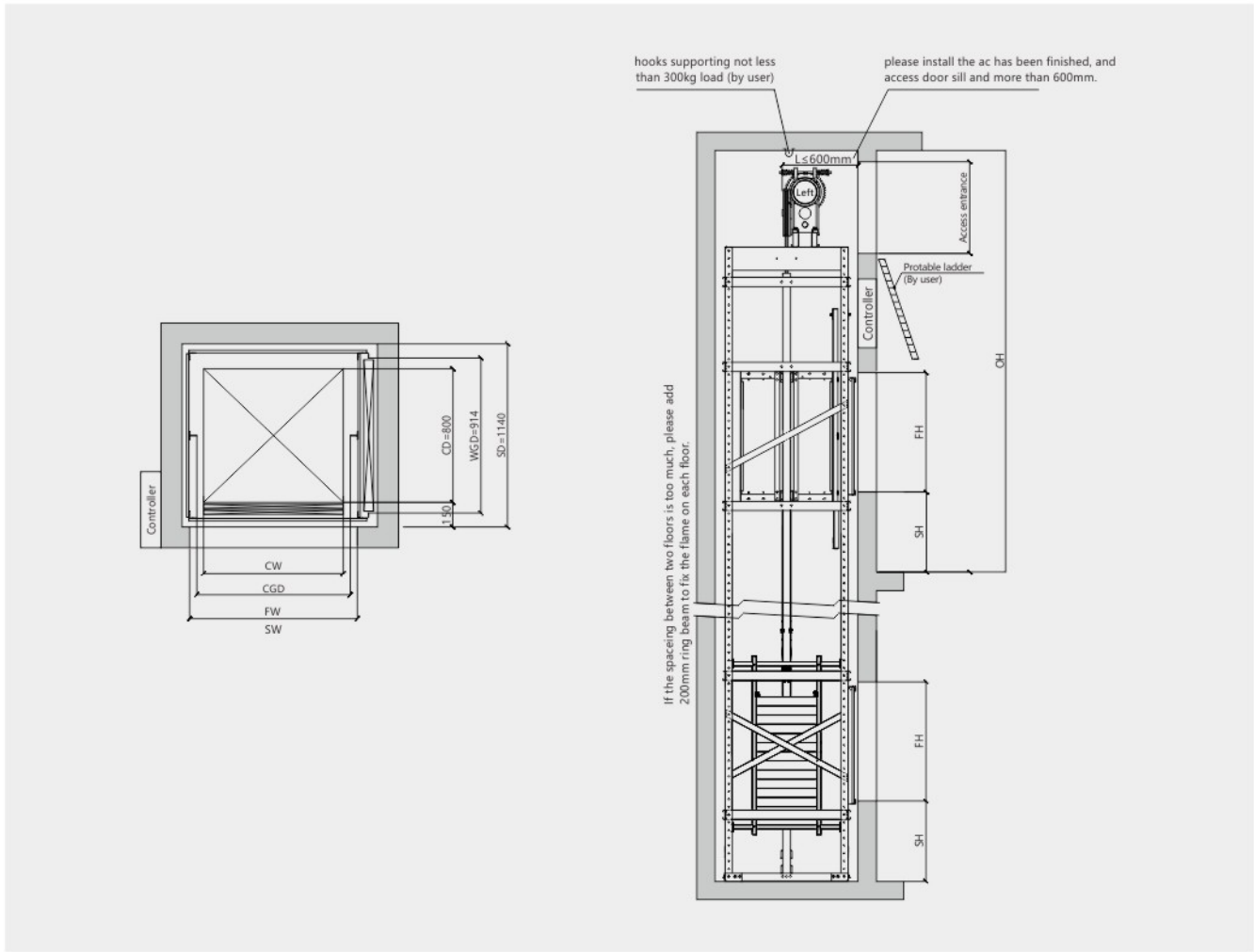

Type	Window type													
Loading capacity	Depth of pit	Car dimension			Bi-Parting door (without car door)				Bi-Parting door (with car door)					
		SH	Width		Depth	Doorway size		Shaft size	Top	Doorway size		Shaft size		Top
			CW	CD		CW	CD			CW	CD	CW	CD	
100kg	700	500	600	600	490	580	900	830	≥3000	490	580	900	900	≥3000
	700	500	600	700	490	680	900	830	≥3100	490	680	900	900	≥3100
	700	600	600	800	590	780	1000	830	≥3200	590	780	1000	900	≥3200
	700	600	700	800	590	780	1000	930	≥3200	590	780	1000	1000	≥3200
200kg	700	700	700	800	690	780	1100	930	≥3200	690	780	1100	1000	≥3400
	700	700	700	800	690	780	1100	1030	≥3200	690	780	1100	1100	≥3400
	700	700	700	900	690	880	1100	1030	≥3300	690	880	1100	1100	≥3400
	700	800	800	900	790	880	1200	1030	≥3400	790	880	1200	1100	≥3400

Type	Ground type													
Loading capacity	Depth of pit	Car dimension			Bi-Parting door (without car door)				Bi-Parting door (with car door)					
		SH	Width		Depth	Doorway size		Shaft size	Top	Doorway size		Shaft size		Top
			CW	CD		CW	CD			CW	CD	CW	CD	
200kg	500	800	800	1000	780	950	1200	1070	≥2900	790	980	1250	1100	≥2900
	500	800	900	1000	780	950	1200	1170	≥3100	790	980	1250	1200	≥3100
	500	900	900	1000	880	950	1300	1170	≥3100	/	/	/	/	/
250kg	500	900	1000	1000	880	950	1300	1235	≥3300	/	/	/	/	/
	500	900	1000	1100	880	1050	1300	1235	≥3500	890	1080	1350	1300	≥3500
	500	1000	1000	1100	980	1050	1400	1235	≥3500	/	/	/	/	/
300kg	650	1000	1000	1200	980	1150	1450	1235	≥3500	990	1180	1450	1300	≥3500

Note:Only for reference,final manufacture please follow contract.